

## Appendix 2.2

---

Proposed Road Infrastructure

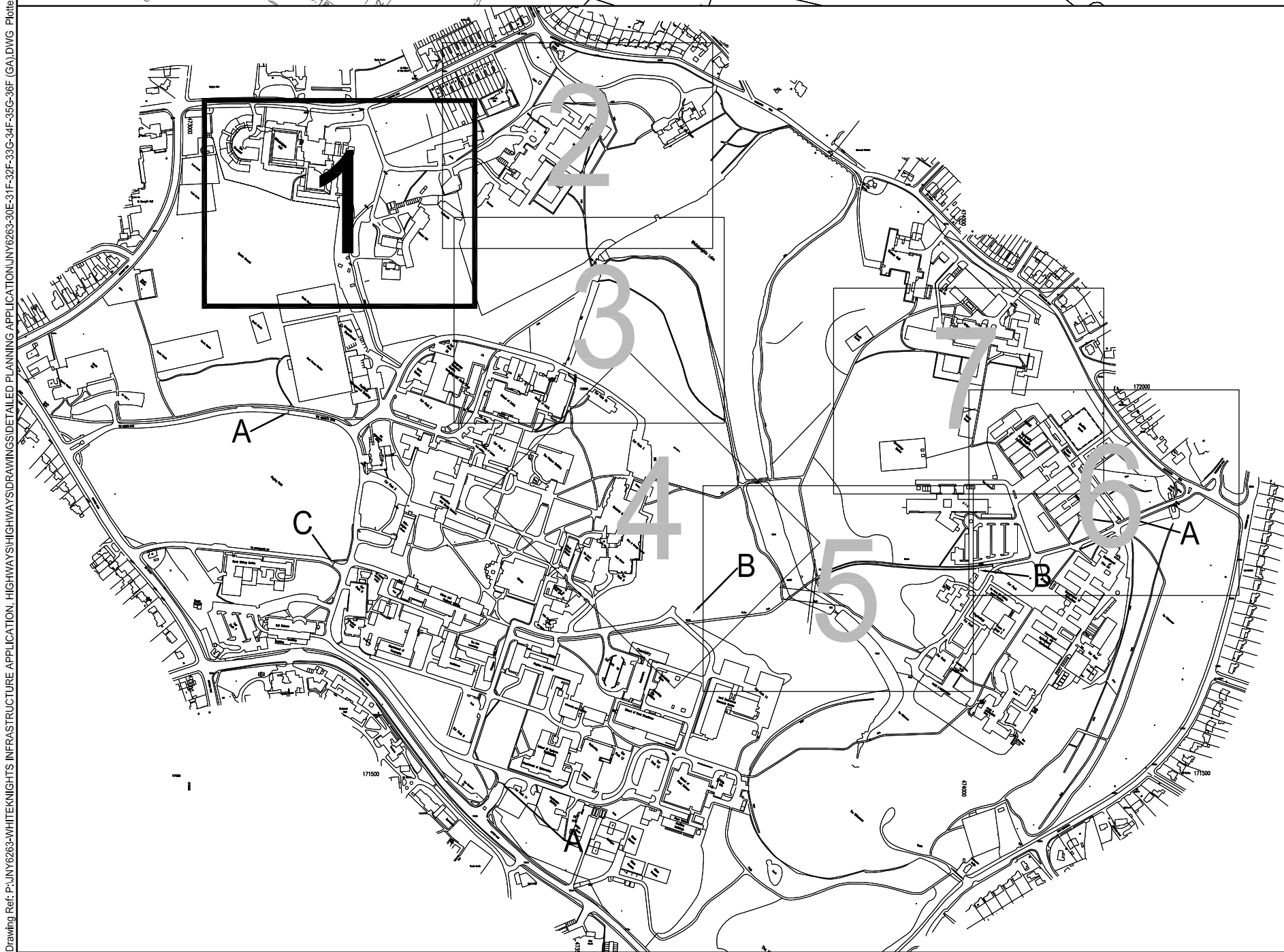

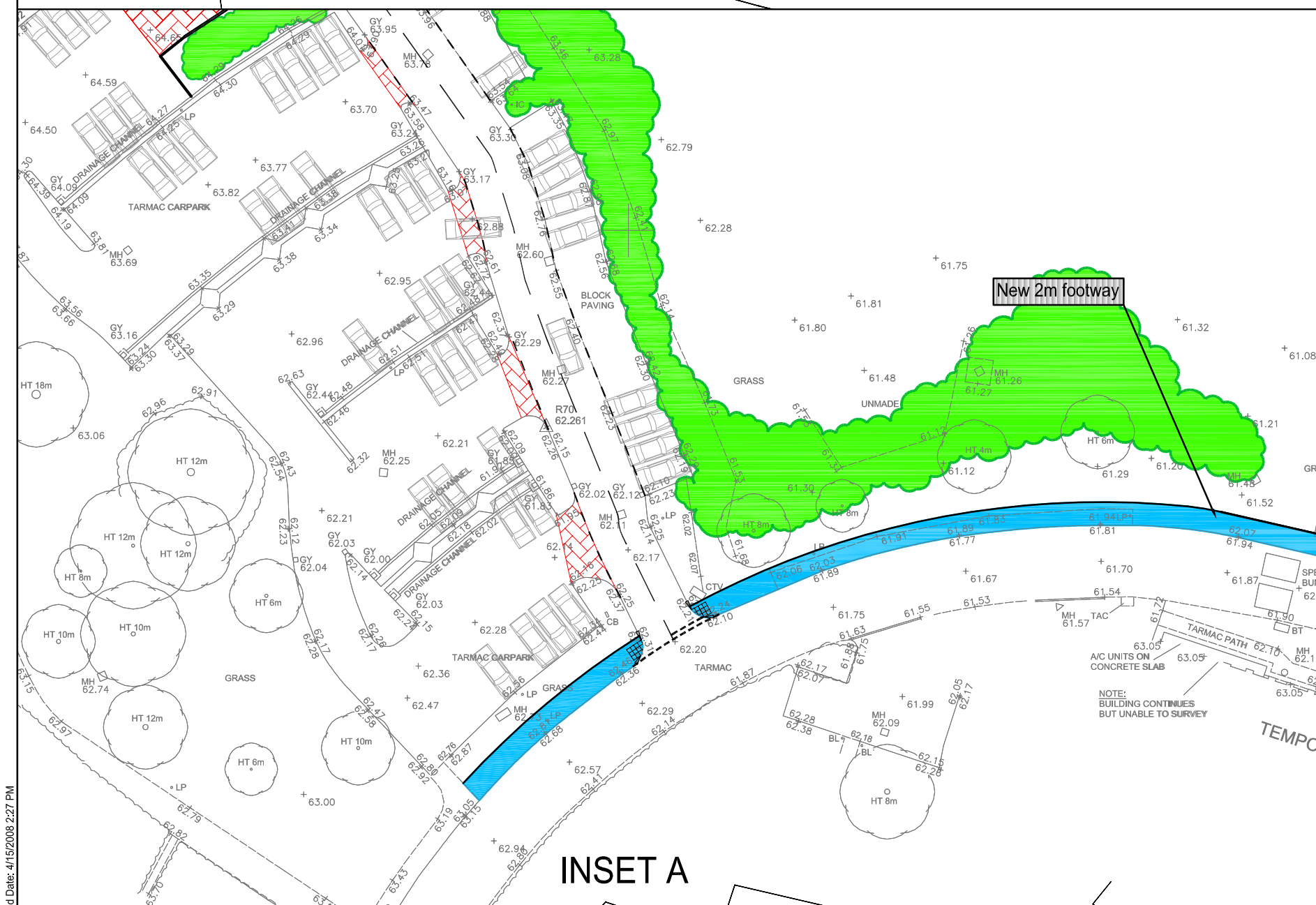
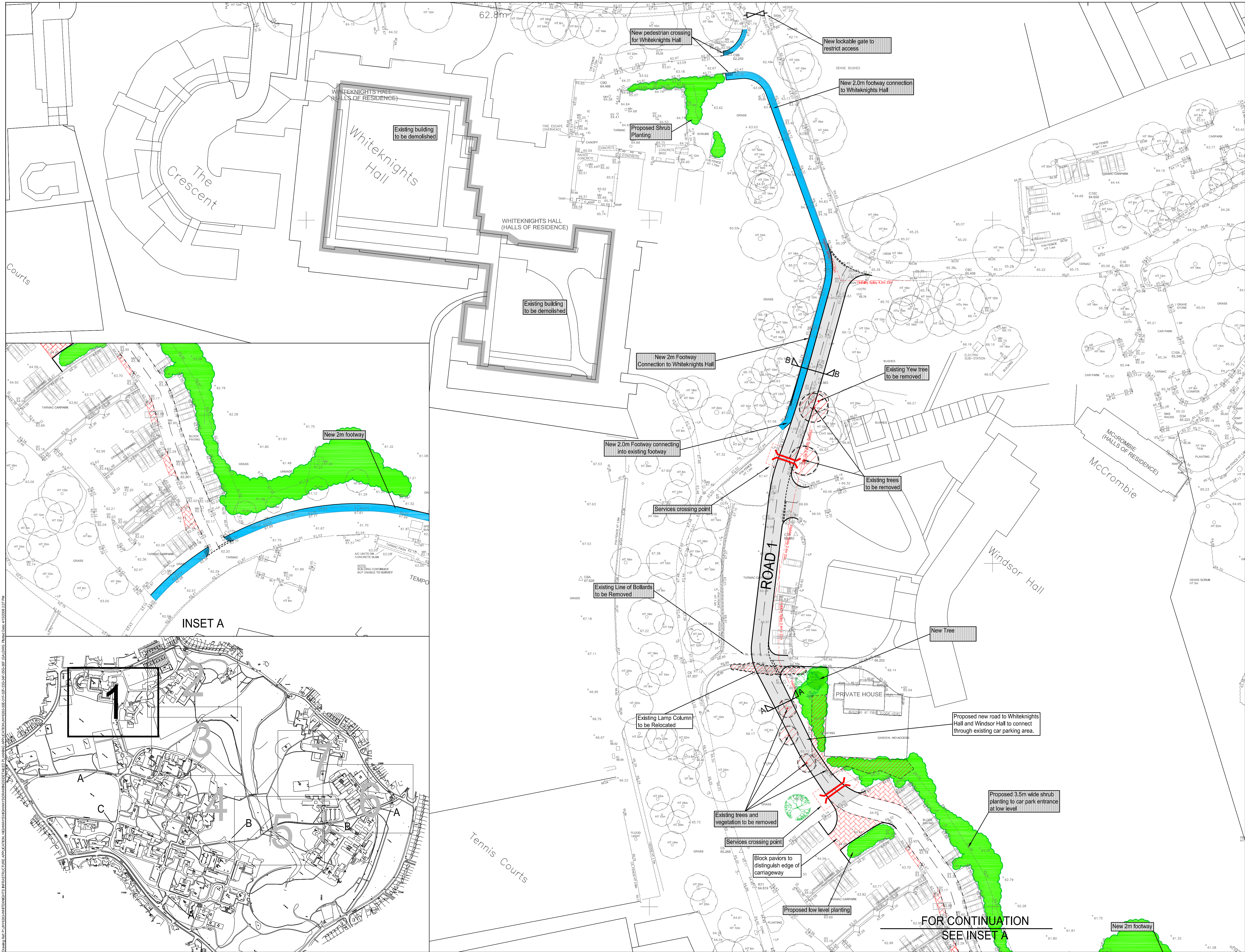

**Legend**

Carriageway Construction

Footway / Cycleway

Proposed Green coloured Surfacing or Block Paviers

Block Paviers

Existing Trees and Vegetation to be Removed

New Trees and Vegetation

A Proposed primary barrier

B Proposed barrier to restricted area

C Relocate one-way barrier

Services crossing with 3m service area.

**NOTES:**

1. Future Lighting Columns to be 5m light duty galvanised steel column PTL50UF/RAL7033-1106010 as supplied by the European Lighting Group Ltd, Reading. Lanterns to be Thorn Riviera RVI/AGPE 27P with OP photo cell and RVI GTP 1070.4 control gear for 70W SON tubular lamps.

2. Lamps to be Philips Master Colour 70W CDO-TT lamps for operating with SON 70W gear.

E	Feb 08	Service crossing points added.	MAL	CM
D	Feb 08	Section markers revised	MAL	CM
C	Jan 08	Alignment Revised	MAL	CM
B	Jan 08	Notes Revised	MAL	CM
A	Jan 08	Alignment revised	MAL	CM
Rev:	Date:	Amendment:	Name:	Checked:

Drawing Based Upon:-

Status:

Notes: Contractors are not to scale from this drawing. All dimensions to be checked on site and any discrepancies, ambiguities and/or omissions between this drawing and information given elsewhere must be reported to this office. If in doubt, ask.

3 London Road  
Newbury  
T 01635 279000 F 01635 279050 E rps@rpsgroup.com W www.rpsgroup.com

Client:

UNIVERSITY OF READING

Project:

Whiteknights Infrastructure Application

Title:

PROPOSED GENERAL ARRANGEMENT  
SHEET 1 of 7

Date:

DEC 07

Scale:

1:500

Paper Size:

A1

Drawn:

AB

Checked:

CM

Job Ref:

JNY6263

Drawing Number:

30

Rev:

E

Transport

FOR CONTINUATION  
SEE INSET A



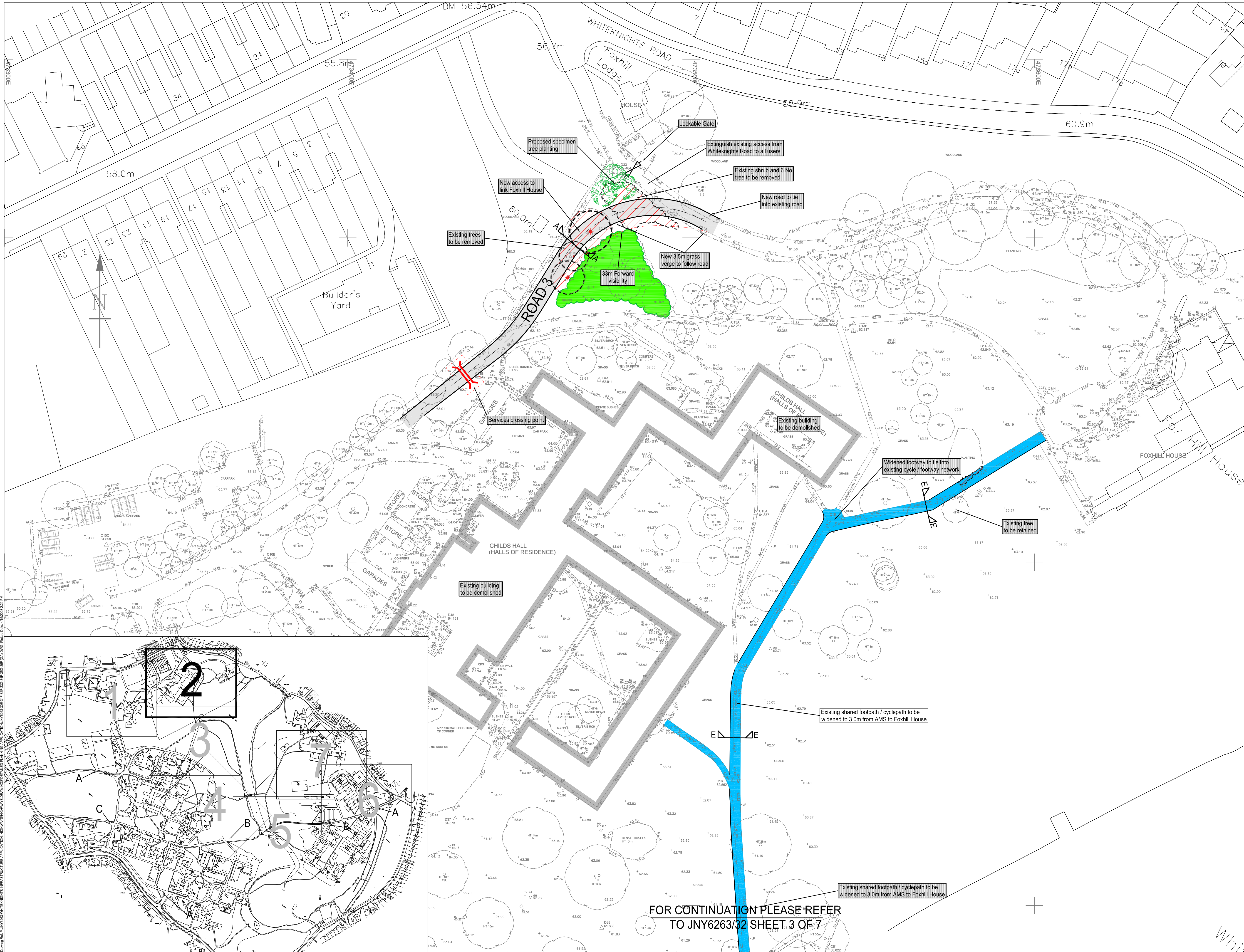

**Legend**

- Carriageway Construction
- Footway / Cycleway
- Proposed Green coloured Surfacing or Block Pavors
- Block Pavors
- Existing Trees and Vegetation to be Removed
- New Trees and Vegetation
- A Proposed primary barrier
- B Proposed barrier to restricted area
- C Relocate one-way barrier
- Services crossing with 3m service area.

- NOTES:**
- Future Lighting Columns to be 5m light duty galvanised steel column PTL50UF/RAL7033-1106010 as supplied by the European Lighting Group Ltd, Reading. Lanterns to be Thorn Riviera RVI/ACPE 27P with OP photo cell and RVI/ GTP 1070.4 control gear for 70W SON tubular lamps.
  - Lamps to be Philips Master Colour 70W CDO-TT lamps for operating with SON 70W gear.

F	Feb 08	Service crossing points added.	MAL	CM
E	Feb 08	Section markers revised	MAL	CM
D	Jan 08	Vegetation for removal updated	MAL	CM
C	Jan 08	Trees for removal updated	MAL	CM
B	Jan 08	Vegetation and trees for removal updated	MAL	CM
A	Jan 08	Footway / cycleway realigned, forward visibility added	AB	CM
Rev:	Date:	Amendment:	Name:	Checked:

**Drawing Based Upon:-**

**Status:**

Notes: Contractors are not to scale from this drawing. All dimensions to be checked on site and any discrepancies, ambiguities and/or omissions between this drawing and information given elsewhere must be reported to this office. If in doubt, ask.

**RPS**

3 London Road Newbury Berkshire RG14 1LL  
T 01635 279000 F 01635 279050 E rps@rpsgroup.com W www.rpsgroup.com

**Client:** UNIVERSITY OF READING

**Project:** Whiteknights Infrastructure Application

**Title:** PROPOSED GENERAL ARRANGEMENT  
SHEET 2 of 7

**Date:** DEC 07 **Scale:** 1:500 **Paper Size:** A1

**Drawn:** AB **Checked:** CM **Job Ref:** JNY6263

**Drawing Number:** 31 **Rev:** F

**Transport**



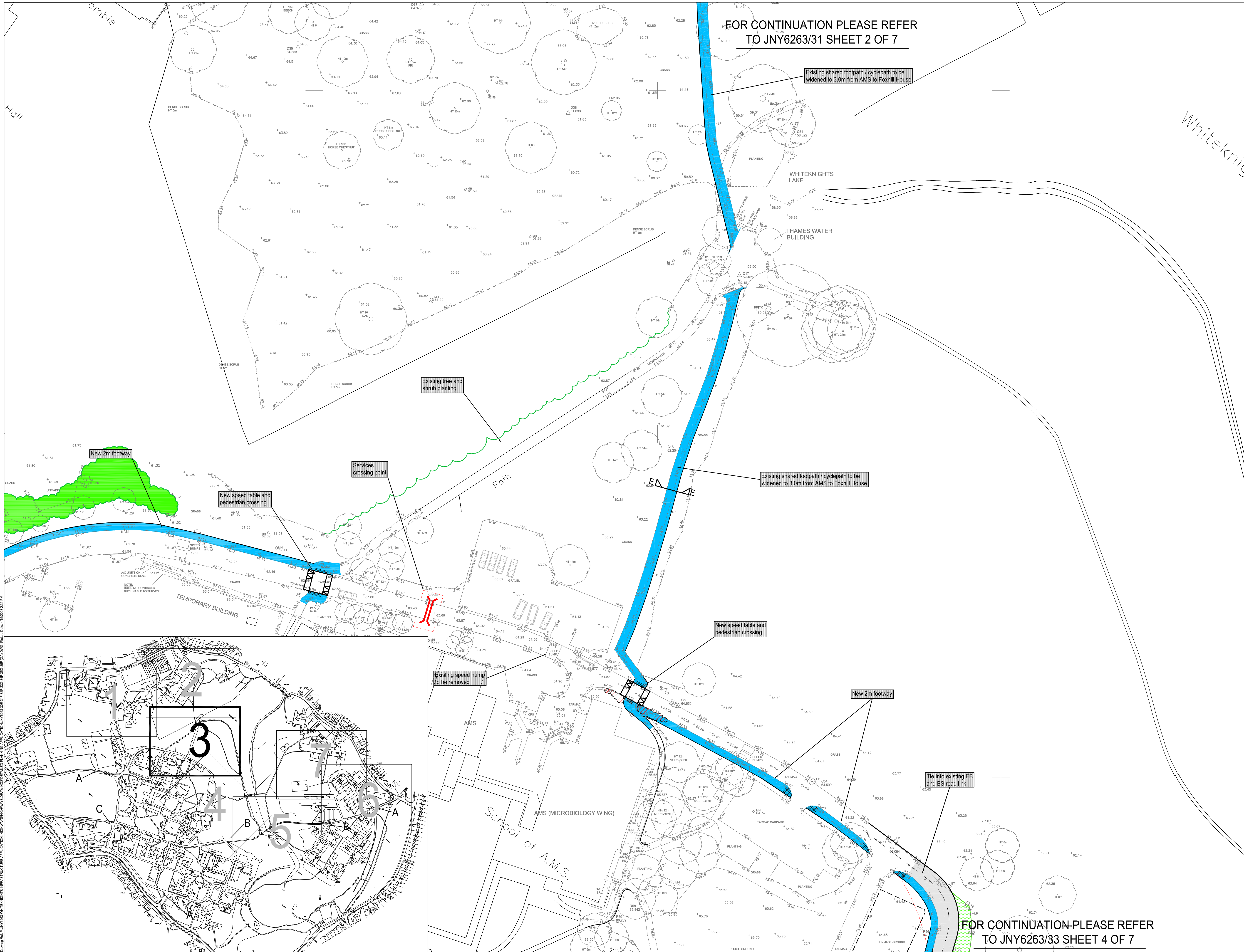

**Legend**

- Carriageway Construction
- Footway / Cycleway
- Proposed Green coloured Surfacing or Block Paviers
- Block Paviers
- Existing Trees and Vegetation to be Removed
- New Trees and Vegetation
- A Proposed primary barrier
- B Proposed barrier to restricted area
- C Relocate one-way barrier
- Services crossing with 3m service area.

- NOTES:**
- Future Lighting Columns to be 5m light duty galvanised steel column PTL50UF/RAL7033-1106010 as supplied by the European Lighting Group Ltd, Reading.
  - Lanterns to be Thorn Riviera RVI/ACPE 27P with OP photo cell and RVI GTP 1070.4 control gear for 70W SON tubular lamps.
  - Lamps to be Philips Master Colour 70W CDO-TT lamps for operating with SON 70W gear.

F	Feb 08	Service crossing points added.	MAL	CM
E	Feb 08	Section markers revised	MAL	CM
D	Jan 08	Key revised	MAL	CM
C	Jan 08	Footpath alignment revised	MAL	CM
B	Jan 08	Notes updated	MAL	CM
A	Jan 08	Table top crossing points added	AB	CM
Rev:	Date:	Amendment:	Name:	Checked:

**Drawing Based Upon:-**

**Status:**

Notes: Contractors are not to scale from this drawing. All dimensions to be checked on site and any discrepancies, ambiguities and/or omissions between this drawing and information given elsewhere must be reported to this office. If in doubt, ask.

**RPS**

3 London Road Newbury Berkshire RG14 1UL  
T 01635 279000 F 01635 279050 E rps@rpsgroup.com W www.rpsgroup.com

**Client:** UNIVERSITY OF READING

**Project:** Whiteknights Infrastructure Application

**Title:** PROPOSED GENERAL ARRANGEMENT  
SHEET 3 of 7

**Date:** DEC 07 **Scale:** 1:500 **Paper Size:** A1

**Drawn:** AB **Checked:** CM **Job Ref:** JNY6263

**Drawing Number:** 32 **Rev:** F

**Transport**



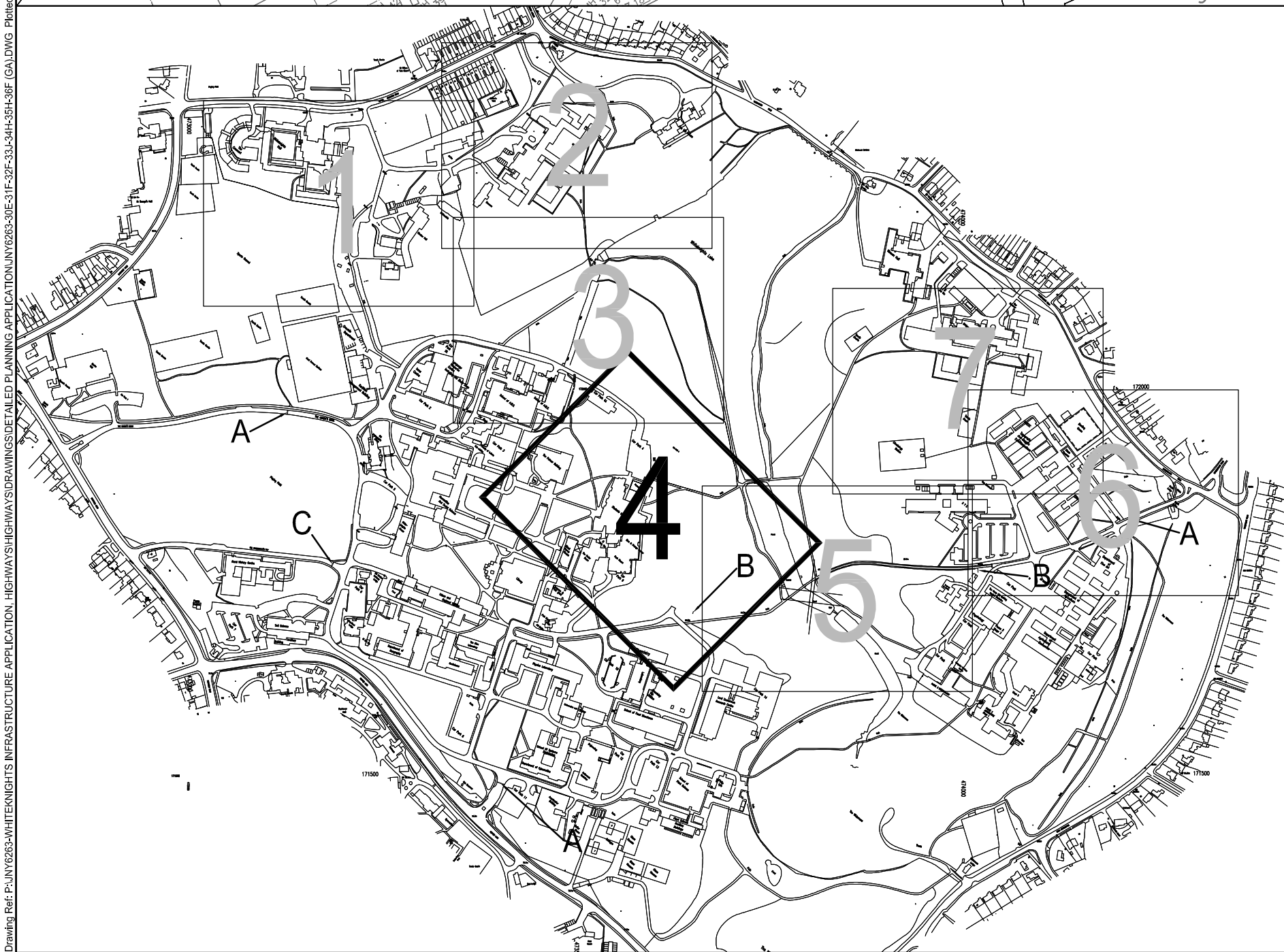
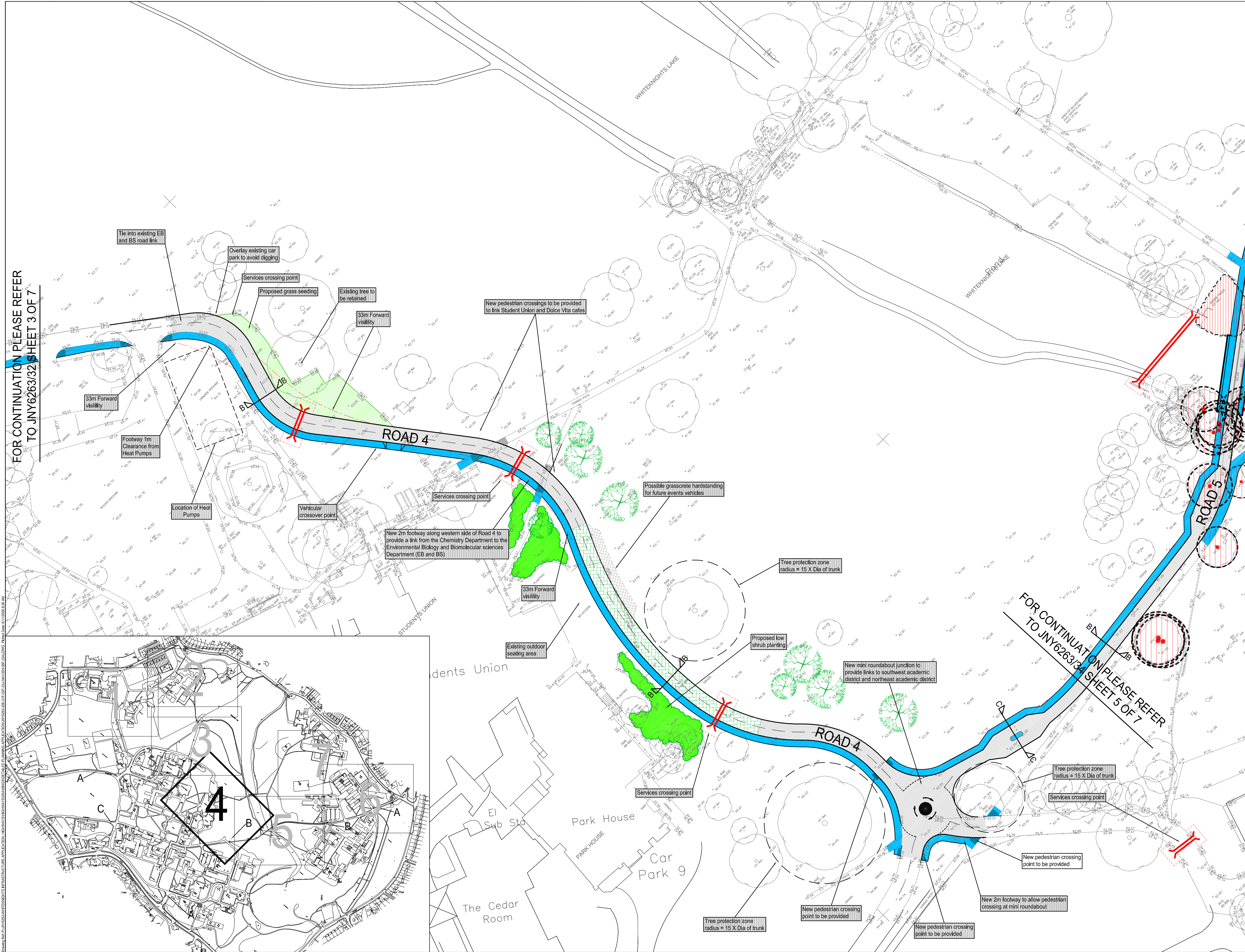

**Legend**

- Carriageway Construction
- Footway / Cycleway
- Proposed Green coloured Surfacing or Block Paviers
- Block Paviers
- Existing Trees and Vegetation to be Removed
- New Trees and Vegetation
- A Proposed primary barrier
- B Proposed barrier to restricted area
- C Relocate one-way barrier
- Services crossing with 3m service area.

**NOTES:**

- Future Lighting Columns to be 5m light duty galvanised steel column PTL50UF/RAL7033-1106010 as supplied by the European Lighting Group Ltd, Reading. Lanterns to be Thorn Riviera RIV1 AGPE 27P with QP photo cell and RIV1 GTP 1070.4 control gear for 70W SON tubular lamps.
- Lamps to be Phillips Master Colour 70W CDO-TT lamps for operating with SON 70W gear.

J	Jun 08	Section markers updated	MAL	CM
H	Apr 08	Alignment revised	MAL	CM
G	Apr 08	Alignment revised	MAL	CM
F	Feb 08	Alignment revised, Service crossing points added.	MAL	CM
E	Feb 08	Alignment revised, Section markers revised	MAL	CM
D	Jan 08	Landscaping Alterations incorporated	MAL	CM
C	Jan 08	Road 4 alignment revised to avoid chambers	MAL	CM
B	Jan 08	Forward visibility and grasscrete area added	MAL	CM
A	Jan 08	Proposed grass seeding and forward visibility added	AB	CM
Rev:	Date:	Amendment:	Name:	Checked:

■ Drawing Based Upon:-

Status:

Notes: Contractors are not to scale from this drawing. All dimensions to be checked on site and any discrepancies, ambiguities and/or omissions between this drawing and information given elsewhere must be reported to this office. If in doubt, ask.

**RPS**

3 London Road Newbury Berkshire RG14 1JA  
T 01635 279000 F 01635 279050 E rps@rpsgroup.com W www.rpsgroup.com

■ Client: UNIVERSITY OF READING

Project: Whiteknights Infrastructure Application

Title: PROPOSED GENERAL ARRANGEMENT SHEET 4 of 7

Date: DEC 07 Scale: 1:500 Paper Size: A1

Drawn: AB Checked: CM Job Ref: JNY6263

■ Drawing Number: 33 Rev: J

Transport



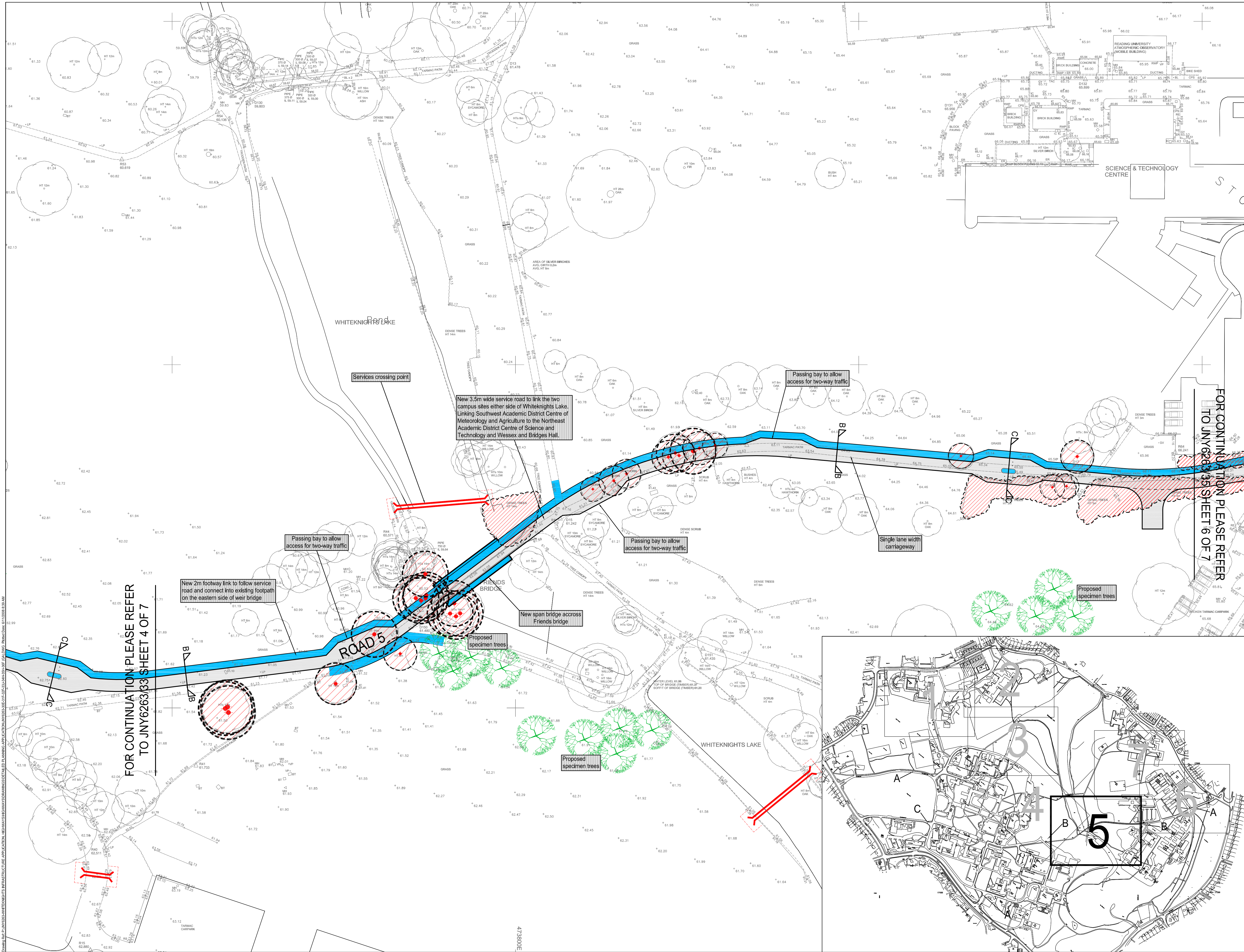

**Legend**

- Carriageway Construction
- Footway / Cycleway
- Proposed Green coloured Surfacing or Block Pavings
- Block Pavings
- Existing Trees and Vegetation to be Removed
- New Trees and Vegetation
- A Proposed primary barrier
- B Proposed barrier to restricted area
- C Relocate one-way barrier
- Services crossing with 3m service area.

**NOTES:**

- Future Lighting Columns to be 5m light duty galvanised steel column PTL50UF/RAL7033-1106010 as supplied by the European Lighting Group Ltd, Reading.
- Lanterns to be Thorn Riviera RVI/ACPE 27P with OP photo cell and RVI GTP 1070.4 control gear for 70W SON tubular lamps.
- Lamps to be Philips Master Colour 70W CDO-TT lamps for operating with SON 70W gear.

H	Jun 08	Section markers updated	MAL	CM
G	Apr 08	Alignment revised	MAL	CM
F	Apr 08	Alignment revised	MAL	CM
E	Feb 08	Passing bay locations revised Service crossing points added	MAL	CM
D	Feb 08	Alignment revised, Section markers revised	MAL	CM
C	Jan 08	Notes revised, Landscaping alterations incorporated	MAL	CM
B	Jan 08	Alignment revised	MAL	CM
A	Jan 08	Notes revised	AB	CM
Rev:	Date:	Amendment:	Name:	Checked:

**Drawing Based Upon:-**

**Status:**  
Notes: Contractors are not to scale from this drawing. All dimensions to be checked on site and any discrepancies, ambiguities and/or omissions between this drawing and information given elsewhere must be reported to this office. If in doubt, ask.

**RPS**  
3 London Road Newbury Berkshire RG14 1LL  
T 01635 279000 F 01635 279050 E rps@rpsgroup.com W www.rpsgroup.com

**Client:** UNIVERSITY OF READING

**Project:** Whiteknights Infrastructure Application

**Title:** PROPOSED GENERAL ARRANGEMENT SHEET 5 of 7

**Date:** DEC 07 **Scale:** 1:500 **Paper Size:** A1

**Drawn:** AB **Checked:** CM **Job Ref:** JNY6263

**Drawing Number:** 34 **Rev:** H

**Transport**







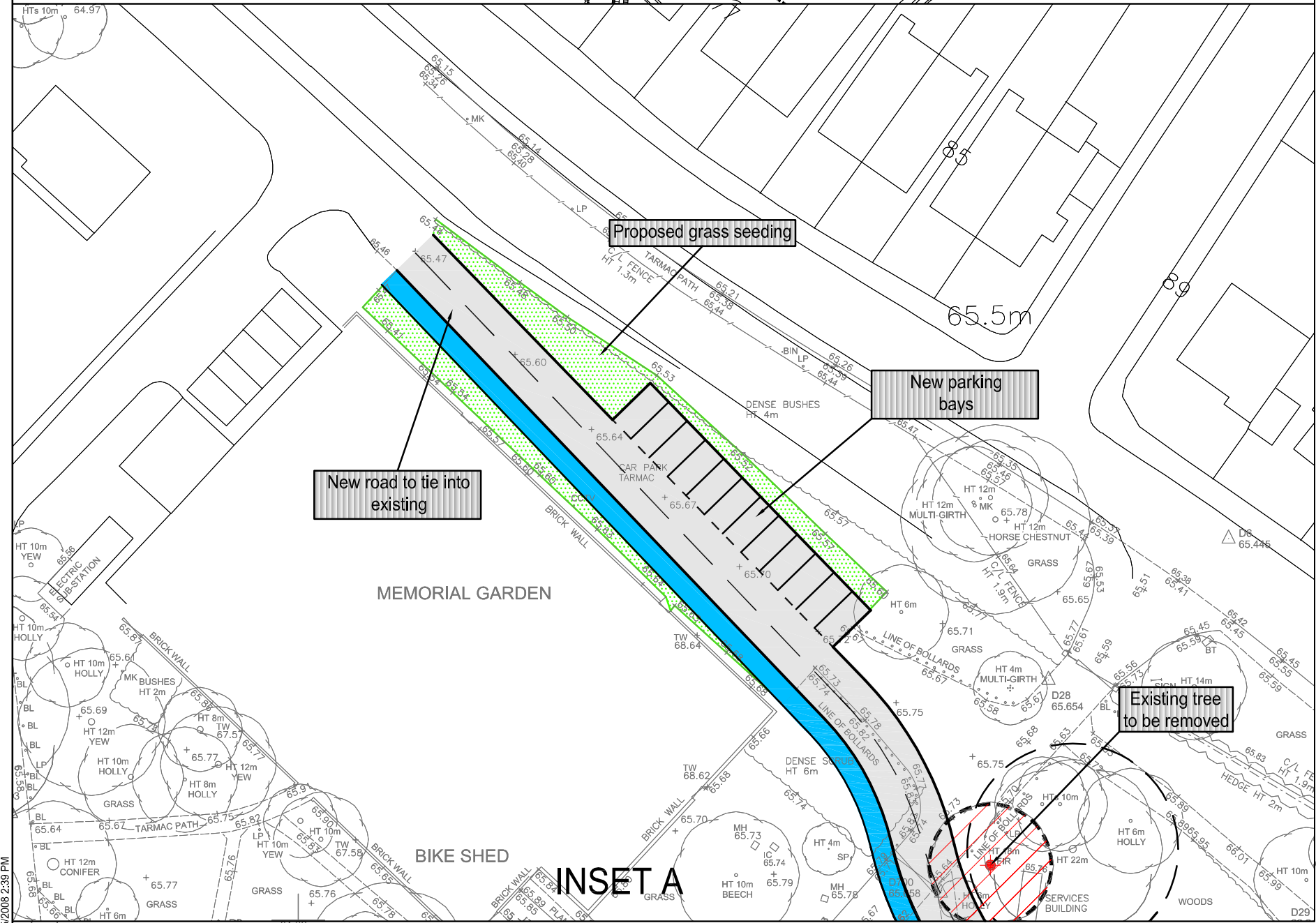
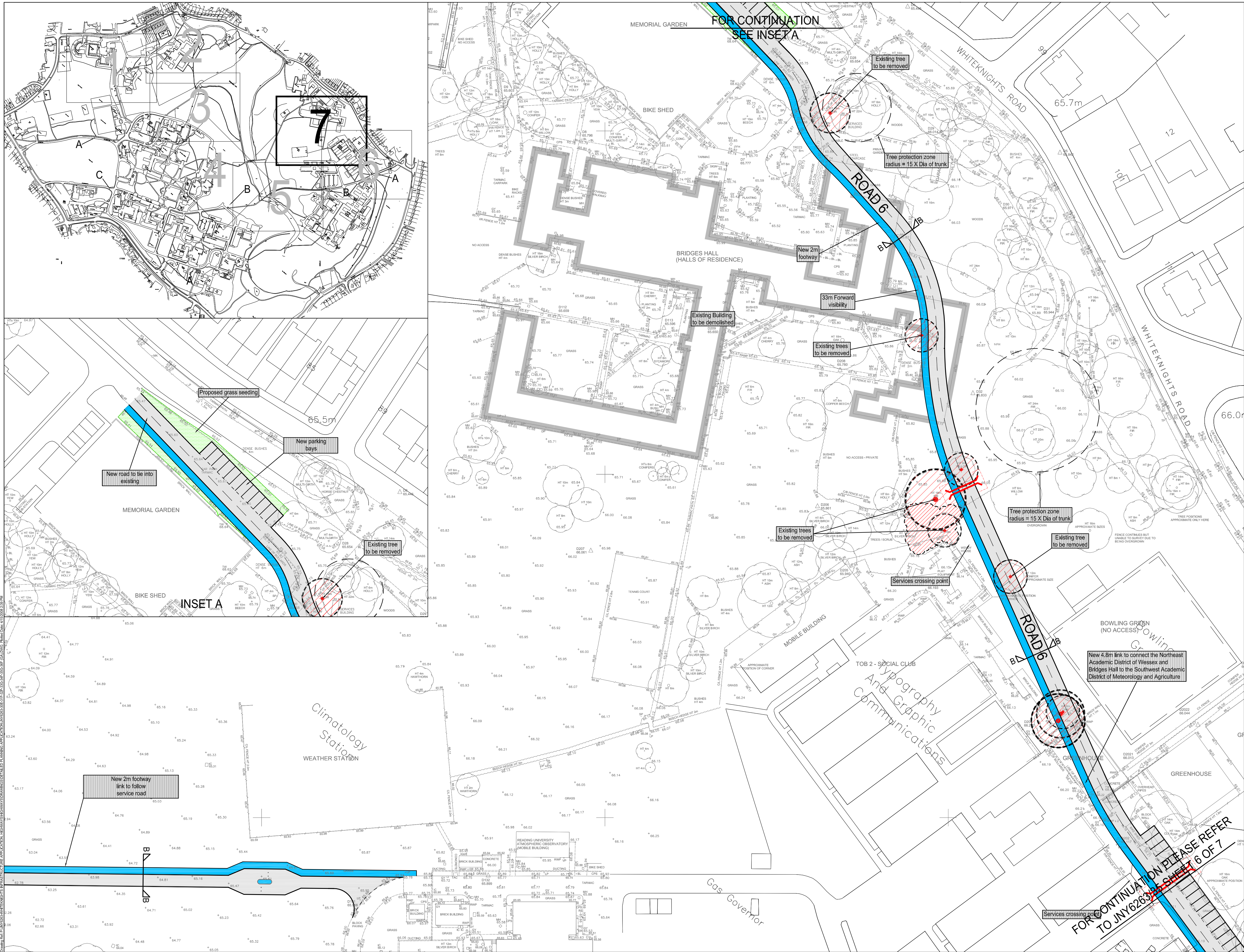

**Legend**

- Carriageway Construction
- Footway / Cycleway
- Proposed Green coloured Surfacing or Block Pavors
- Block Pavors
- Existing Trees and Vegetation to be Removed
- New Trees and Vegetation
- A Proposed primary barrier
- B Proposed barrier to restricted area
- C Relocate one-way barrier
- Services crossing with 3m service area.

**NOTES:**

- Future Lighting Columns to be 5m light duty galvanised steel column PTL50UF/RAL7033-1106010 as supplied by the European Lighting Group Ltd, Reading. Lanterns to be Thorn Rivera RVI ACPE 27P with OP photo cell and RVI GTP 1070.4 control gear for 70W SON tubular lamps.
- Lamps to be Philips Master Colour 70W CDO-TT lamps for operating with SON 70W gear.

F	Feb 08	Service crossing points added.	MAL	CM
E	Feb 08	Section markers revised	MAL	CM
D	Jan 08	Landscaping alterations, road & Footpath alignment revised	MAL	CM
C	Jan 08	Alignment revised	MAL	CM
B	Jan 08	Legend updated	MAL	CM
A	Jan 08	Realignment of road 6, tactile paving added to road 5	AB	CM
Rev:	Date:	Amendment:	Name:	Checked:

■ Drawing Based Upon:-

**Status:**  
Notes: Contractors are not to scale from this drawing. All dimensions to be checked on site and any discrepancies, ambiguities and/or omissions between this drawing and information given elsewhere must be reported to this office. If in doubt, ask.

3 London Road  
Newbury  
T 01635 279000 F 01635 279050 E rps@rpsgroup.com W www.rpsgroup.com

■ Client: UNIVERSITY OF READING

Project: Whiteknights Infrastructure Application

Title: PROPOSED GENERAL ARRANGEMENT  
SHEET 7 of 7

Date: DEC 07 Scale: 1:500 Paper Size: A1

Drawn: AB Checked: CM Job Ref: JNY6263

■ Drawing Number: 36 Rev: F

Transport

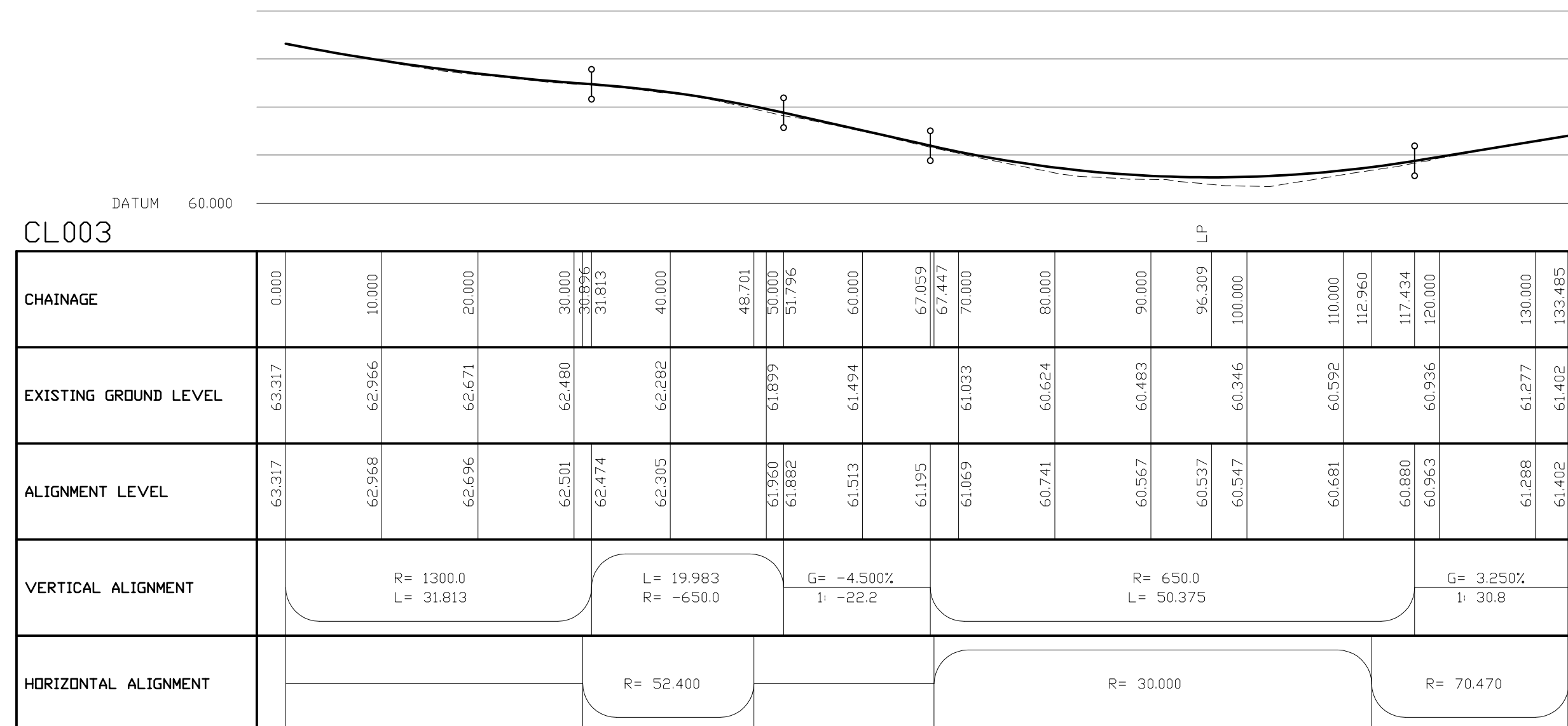
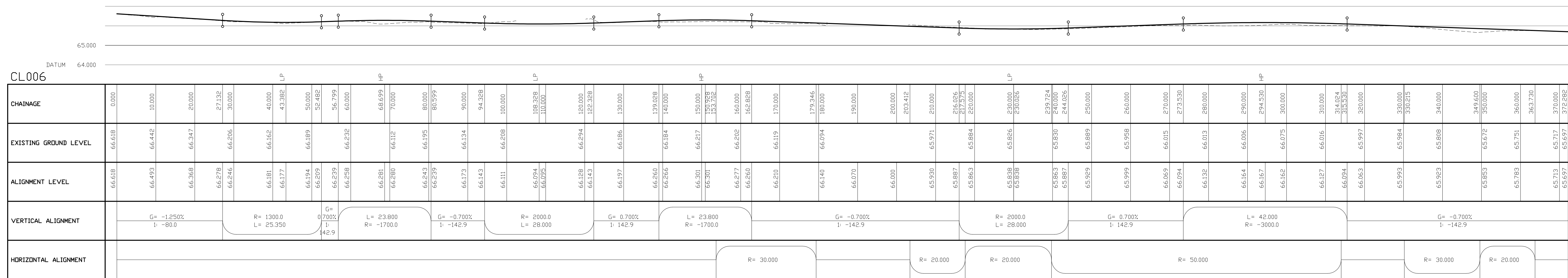

Transport





Existing kerbing  
and carriageway



Note - On frost susceptible soils a minimum thickness of carriageway construction of 450mm is required, the sub-base thickness may need to be increased or the sub-grade made non-frost susceptible by the stabilisation of the soil.

### Legend

C	Jun 08	Bridge Section Removed	MAL	CM
B	Feb 08	Construction Details Added	MAL	CM
A	Feb 08	Sections Updated	MAL	CM
Rev:	Date:	Amendment:	Name:	Checked:

- Drawing Based Upon:-

Status:

Notes: Contractors are not to scale from this drawing. All dimensions to be checked on site and any discrepancies, ambiguities and/or omissions between this drawing and information given elsewhere must be reported to this office. If in doubt, ask.



3 London Road Newbury Berkshire RG14 1JL  
T 01635 279000 F 01635 279050 E [rspsne@rpsgroup.com](mailto:rspsne@rpsgroup.com) W [www.rpsgroup.com](http://www.rpsgroup.com)

Client: UNIVERSITY OF READING

Project: Whiteknights Infrastructure Application

Title: Long Sections and Typical Cross Sections  
SHEET 2 of 2

Date: DEC 07 Scale: 1:25 Paper Size: A1

Drawn: AB      Checked: CM      Job Ref: JNY6263

■ Drawing Number: 38 Rev: C

Transport



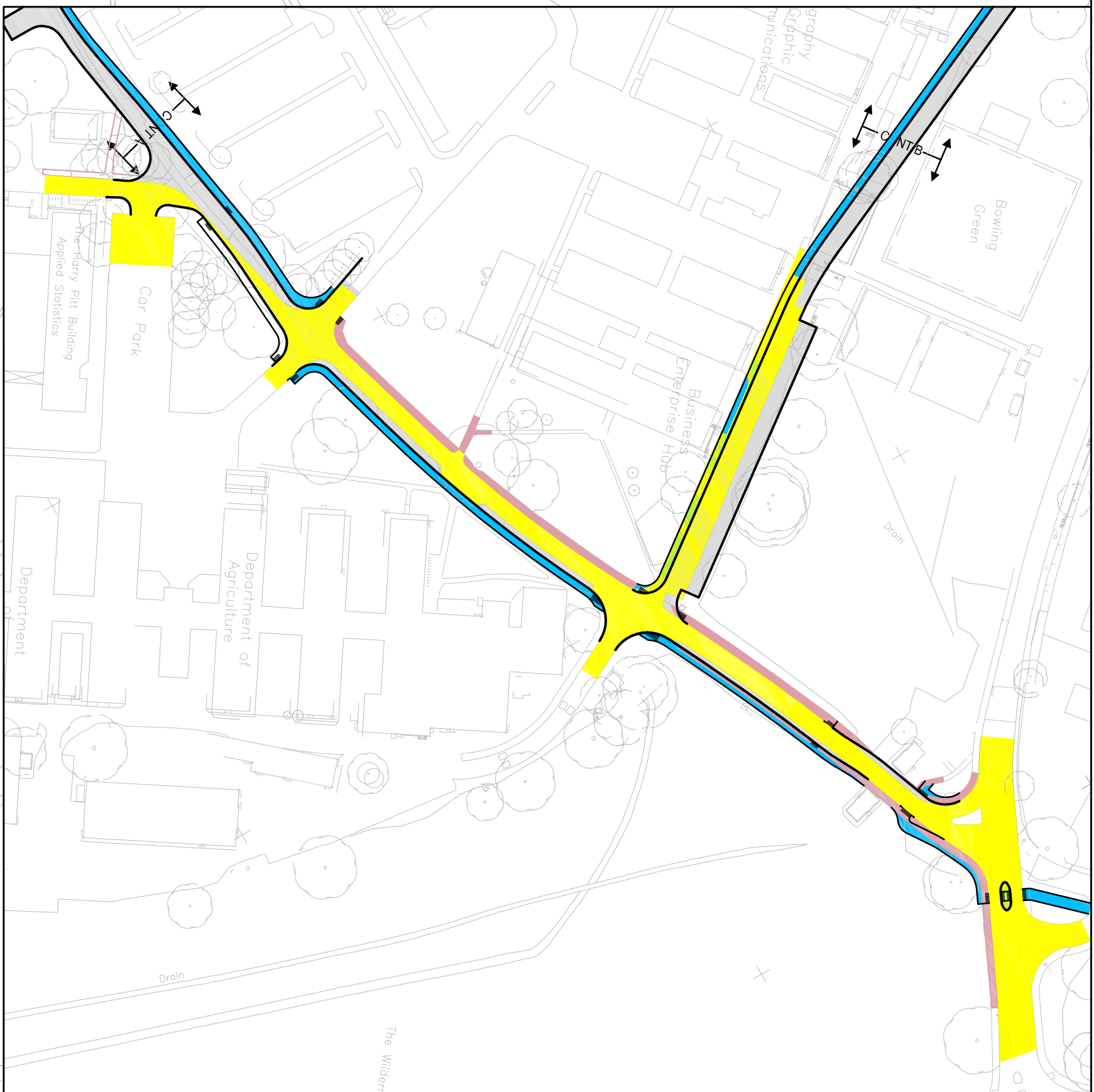
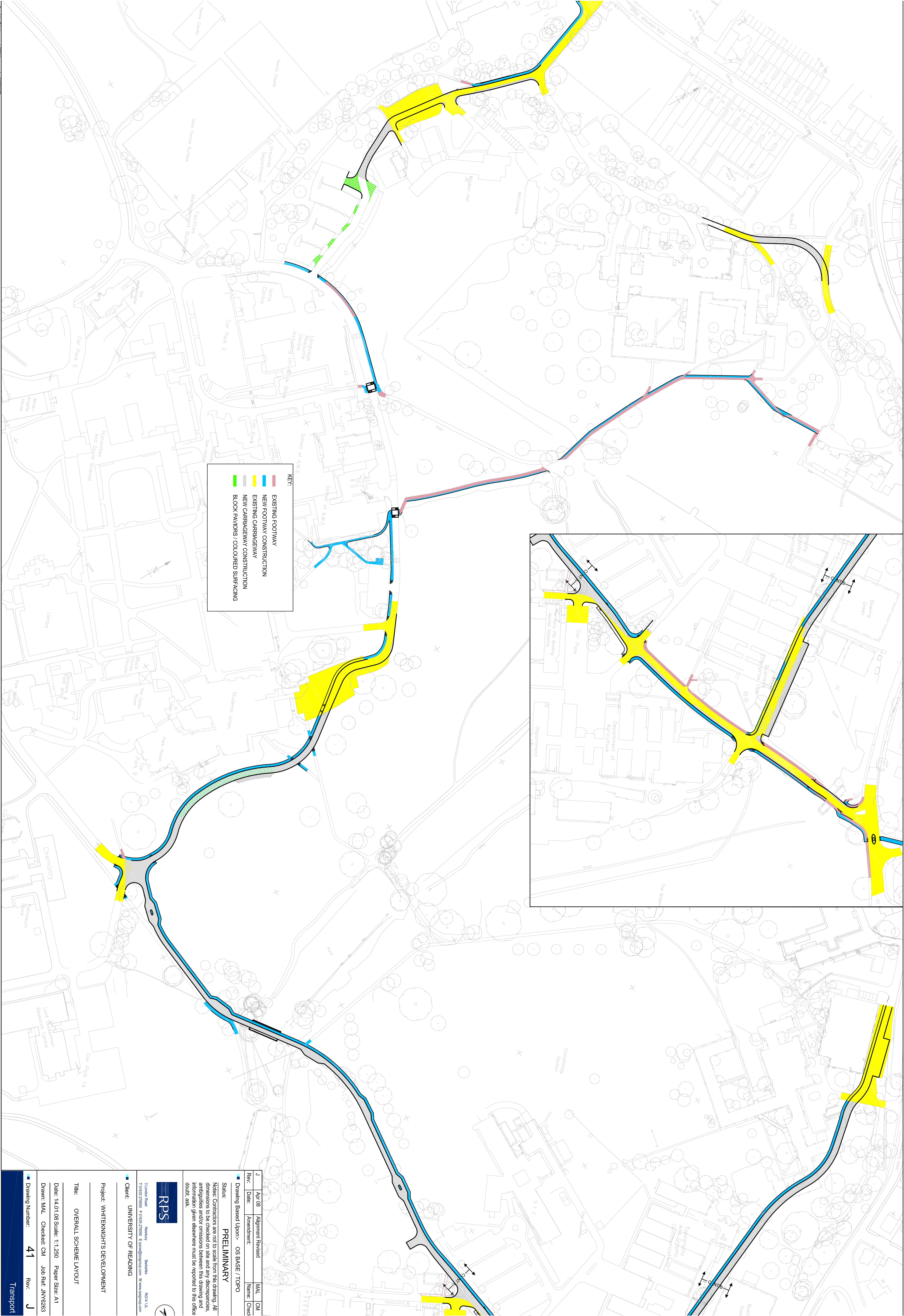

U	Apr 08	Alignment Revised	MAL	CM
Rev:	Date:	Amendment:	Name:	Client

■ Drawing Based Upon: OS BASE / TOPO

State: PRELIMINARY

Notes: Contractors are not to scale from this drawing. All dimensions to be checked on site and any discrepancies, omissions and/or omissions between this drawing and the site conditions must be reported to the office forthwith.

RPS

3 London Road  
Totton, Hampshire  
SO40 2JF  
Tel: 01703 279900  
Fax: 01703 279901  
Email: [info@rps.co.uk](mailto:info@rps.co.uk)  
Website: [www.rps.co.uk](http://www.rps.co.uk)

Beckwith  
RGS 141

Client: UNIVERSITY OF READING

Project: WHITEKNIGHTS DEVELOPMENT

Title: OVERALL SCHEME LAYOUT

Date: 14.01.08 Scale: 1:1,250 Paper Size: A1

Drawn: MAL Checked: CM Job Ref: JIN6253

Drawing Number: 41 Rev: J

Transport